



LOAD CELL C, CD - 1,25t to 20t

FOR TENSION LOADS

The load cells are the load sensors in S-E-G weighing systems. They are installed as support points for objects to be weighed and sense their weight. The elasticity of the load cell when subjected to a load is measured with strain gauges which transform the load-induced deflection into a proportional electrical signal.

Load cells type C and CD are intended for tension loads. They are primarily used to weigh containers and other objects suspended by the load cells.

Type C load cells are designed for rated loads from 1,25 ton to 20 tons. Lifting eyes are available according to SMS 1577 standard.



DESIGNATIONS AND SPECIFICATIONS

Load cells are identified by a 3-unit code:

TYPE	CLASS	RESISTANCE	—	RATED LOAD
------	-------	------------	---	------------

The codes are explained in the table below:

Load cells are delivered with 7m cable.

Code example:

CN4-20. A load cell type C, class 0,2 with terminal resistance of 430 ohms and a rated load of 20 tons.

CLASS - max. error as a % of load rating, calibration tolerance not included.		0,2	
DESIGNATION	Type	C	CD
	Class designation	N	N
	Resistance (4 = 430 ohms)	4	4
	1,25 ton	•	•
	2,5	•	
	5	•	
Rated load designated R.L. below.	10	•	
	20	•	
SPECIFICATIONS - max. values for class and rated load respectively			
Continuous overload	%	25	
Brief, temporary overload - elicits no permanent damage	%	60	
Overload, ultimate level	%	300	
Mechanical deflection at R.L.	mm	~0,2	
Lateral load relative to R.L. - can alter the output voltage +/- 0,5% of R.L.	%	15	
Calibration tolerance relative to Actual Load	±%	0,25	
Sum of non-linearity, hysteresis and creep errors (30 min.) relative to R.L.	±%	0,15	
Repeatability errors relative to R.L.	±%	0,05	
Temperature effect on zero balance relative to R.L.	±%/10°C	0,1	
Temperature effect on output voltage relative to actual load *)	±%/10°C	0,1	
Operating temperature	°C	70	
GENERAL SPECIFICATIONS FOR ALL CLASSES AND LOAD RATINGS			*) Specifications are independent of resistances in the connecting wires for input voltage.
Output voltage at R.L.: 1 mV/V. Zero unbalance (bias) +/- 0,01 mV/V.			
Recommended input voltage: 15V. Max. 21V.			
Temperature effect is compensated within -10 to +50°C.			
Sealing: IEC IP 67 (SEN S55). Tested and approved by S.P. (The Swedish national testing institute).			

DIMENSIONS and WEIGHT

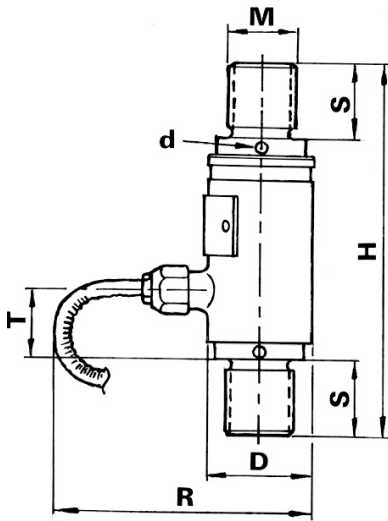

Type	Rated load (tons)	Dimensions (mm)							Weight kg
		D	H	d	M	S	R	T	
C	2.5	50	128	7	30x2	40	140	46	3.5
C	5	60	138	7	48x3	50	145	46	5
C	10	75	170	7	48x3	50	155	65	6.5
C	20	100	200	8	72x4	75	165	70	12
CD	1.25	50	128	7	30x3	40	140	46	3
D	2.5	50	128	7	36x4	40	140	46	4

ELECTRICAL CONNECTION Markings

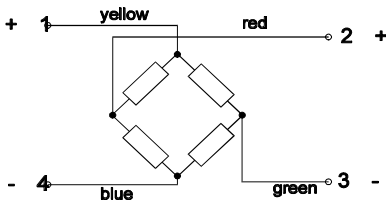

Cable with nipples

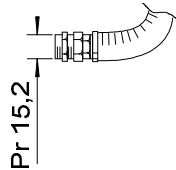

Terminal box type A (Optional)

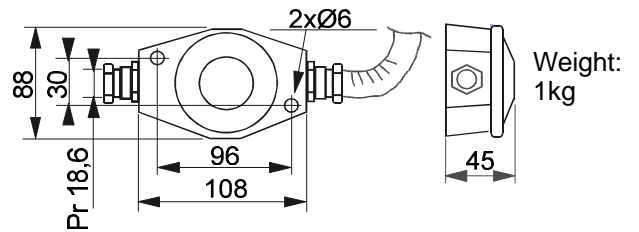

MOUNTING ACCESSORIES

Lifting eye Type H

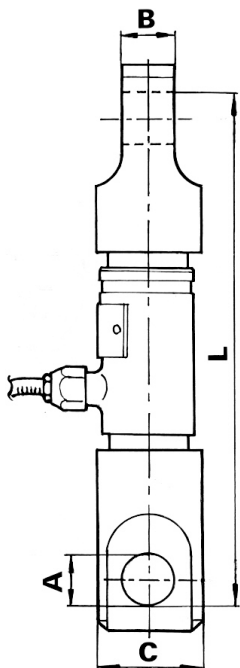

Lifting eye Type LH

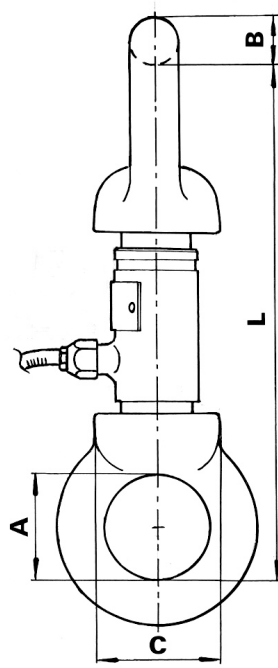

Lifting eye Type H

For load cell type C.

Designed for std. shackles SMS 1577.

Lifting eye Type LH

For load cells type CD.

Std eye SMS 15, DIN 582.

Eye type	Load cell		Dimensions (mm)				Weight kg
	type	rated load	A	B	C	L	
H-2	C	1,25	30	33	60	310	1
	C	2,5					
H-10	C	5	51	60	90	415	3
	C	10					
H-20	C	20	72	85	140	635	15
LH	CD	1,25	75	33	75	360	2,6
	D	2,5					